

Overview

Pre-Insulated Sleeve MJPF

Material: Brass(silver plating)Aluminium

Product property: MJPF is designed to connect the neutral messenger in aerial bundled cable .It is in accordance with NFC33-021 .The sleeve is with full tension .

And it's cap can prevent the water into the barrel .It is colored differently to distinguish the cable sizes .

Marked with type ,cable size ,die size ,inner cable length and number of crilnping .

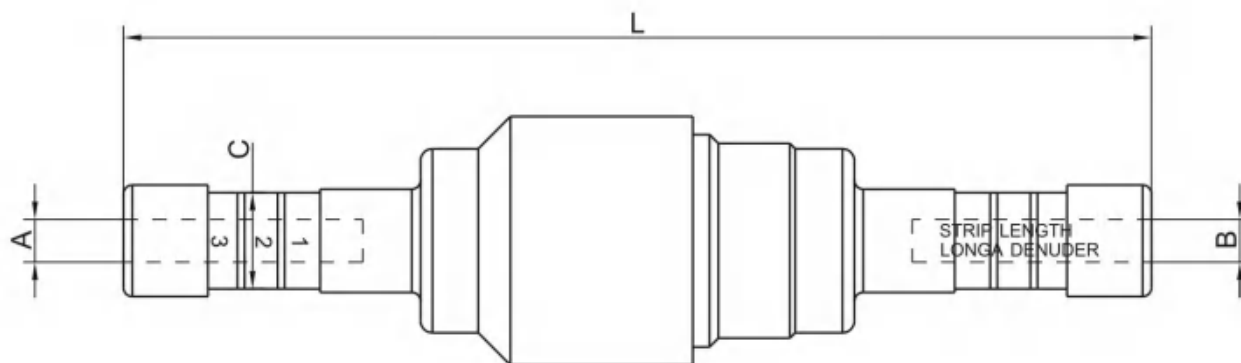

Model	Cable Size (mm2)		Plastic Sleeve Diameter (mm)	Length (mm)
	A	B	C	L
MJPF 16/16	16	16	16.2	174

MJPF 16/25	16	25	16.2	174
MJPF 25/25	25	25	16.2	174

Pre-Insulated Sleeve SDPA

Material: Aluminum alloy

Product property: SDPA is designed to connect the neutral messenger in aerial bundled cable . It is in accordance with NFC33-021 .The sleeve is with full tension .

And its cap can prevent the water into the barrel .It is colored differently to distinguish the cable sizes .

Marked with type ,cable size ,die size ,inner cable length and number of crimping .

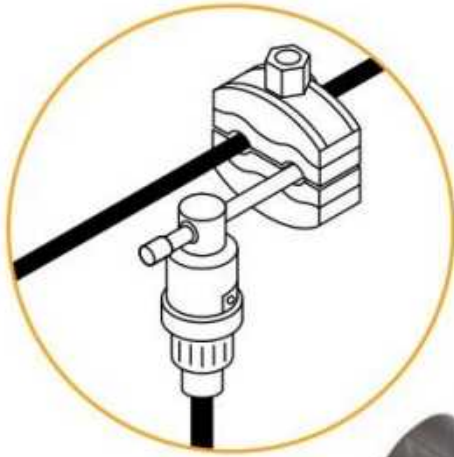

Model	Cable Size (mm2)		Plastic Sleeve Diameter (mm)	Length (mm)
	A	B	C	L
MJPTN 54.6/54.6	54.6	54.6	20	172.5
MJPTN 54.6/70	54.6	70	20	172.5
MJPTN 70/70	70	70	20	172.5
MJPTN 95/95D	95	95	20	172.5